



NAV BHARAT ENGINEERS

9/424, "Bhagyodaya", Kher Nagar, Bandra (E), Mumbai - 400 051.

Tel. : +91 22 2647 3797 /Telefax : 91 22 2647 8893

E-mail : navengg@mtnl.net.in / navengg@vsnl.com / Net : www.ne-india.com

KNOCKOUT PUNCHES

NE Knockout Punches are a boon for panel manufacturers, electrical contractors and for offshore projects

NE Knockout Punches are very useful for punching big holes in sheet metal and panels, a job which is otherwise difficult, tedious and time consuming, more so when the panel is very big. It is just unsurpassable for punching such holes on existing panels at site



NE Knockout Punches can punch holes within a minute, ranging from 12 mm to 125 mm diameter in sheet metal thickness up to 10 gauges (3 mm approx.). **Special punches** can be supplied for making holes of square, rectangular or other shapes as desired

Available in wrench driven, hand, and hydraulic models

Method of using wrench driven knockout punches

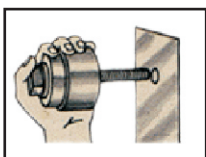

1. Insert the stud through pilot holes.

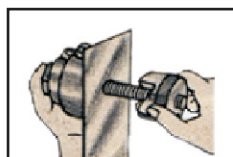

2. Thread punch on the stud.

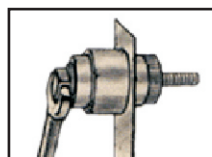

3. Rotate the stud with suitable wrench

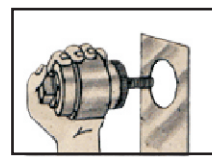

4. Remove from the hole.

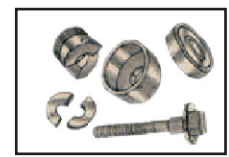

5. Unscrew punch from the stud, remove die and shake out split slug.

Benefits of Hydraulic knockout punch driven with hand pump over Wrench driven knockout punches.

- Fast, easy and simple to operate, punches holes three times faster than wrench method.
- Takes very less amount of cutting load
- Life of stud is enhanced
- Cutting in the corner of panel or where one cannot rotate the wrench easily the use of hand hydraulic is necessary
- Additional holes can be made in switch-board doors and panels even after **they have been wired and fitted**

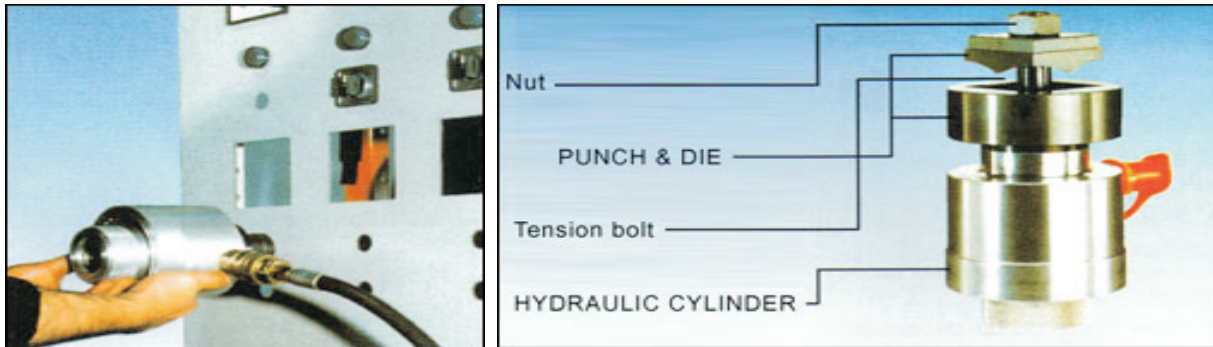

Standard circular sizes of knowkout punches available are

ACTUAL HOLE	PILOT HOLE	ACTUAL HOLE	PILOT HOLE	ACTUAL HOLE	PILOT HOLE	ACTUAL HOLE	PILOT HOLE
12.7	8.00	31.75	19.00	55	19.00	80	19.00
15.9	10.00	34.6	19.00	57.15	19.00	82.55	19.00
19.05	10.00	35	19.00	60	19.00	85	19.00
20	13.00	38.1	19.00	61.5	19.00	88.9	19.00
22.4	13.00	40	19.00	63.5	19.00	89.8	19.00
23	13.00	43.2	19.00	65	19.00	90	19.00
25	13.00	44.45	19.00	69.9	19.00	95	19.00
25.4	13.00	45	19.00	70	19.00	95.25	19.00
28.2	13.00	49.6	19.00	74.00	19.00	100	19.00
30	13.00	50.00	19.00	75	19.00	101.6	19.00
31	19.00	50.8	19.00	76.2	19.00	102.7	19.00

The recommended shapes that can be done with Slug-O-Ster Knockout Punches other than circular are as under

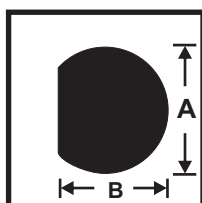

1. 'D' SHAPE

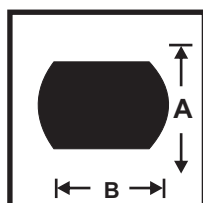

2. DOUBLE 'D' SHAPE

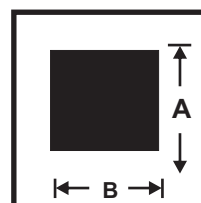

3. SQUARE SHAPE

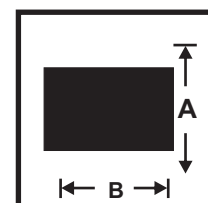

4. RECTANGULAR SHAPE